

TYPE INLET	INSIDE DIMENSIONS
B-5	5'(length) x 2'(wide) w/Exception of side ejection SEE DETAIL
B-10	10'(length) x 10'(wide) w/Exception of side ejection SEE DETAIL
B-15	15'(length) x 5'(wide) w/Exception of side ejection SEE DETAIL
B-20	20'(length) x 10'(wide) w/Exception of side ejection SEE DETAIL
B-25	25'(length) x 5'(wide) w/Exception of side ejection SEE DETAIL
B-30	30'(length) x 10'(wide) w/Exception of side ejection SEE DETAIL

SECTION A-A
NOT TO SCALE

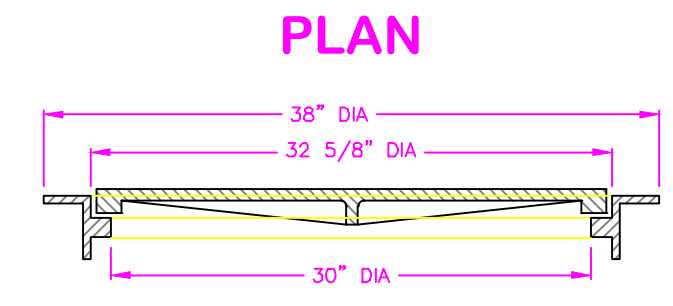

FRAME AND COVER DETAIL
NOT TO SCALE

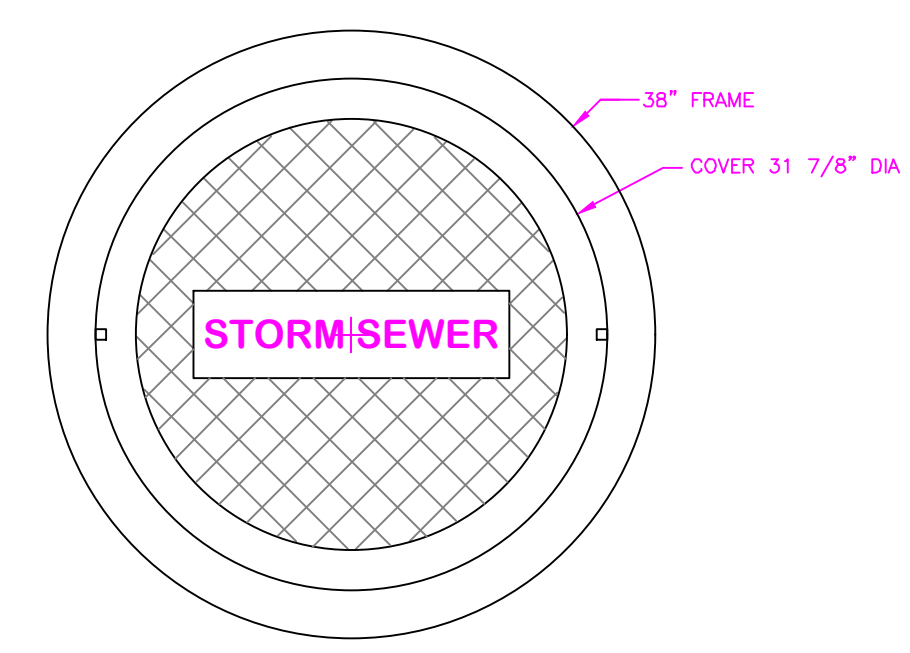
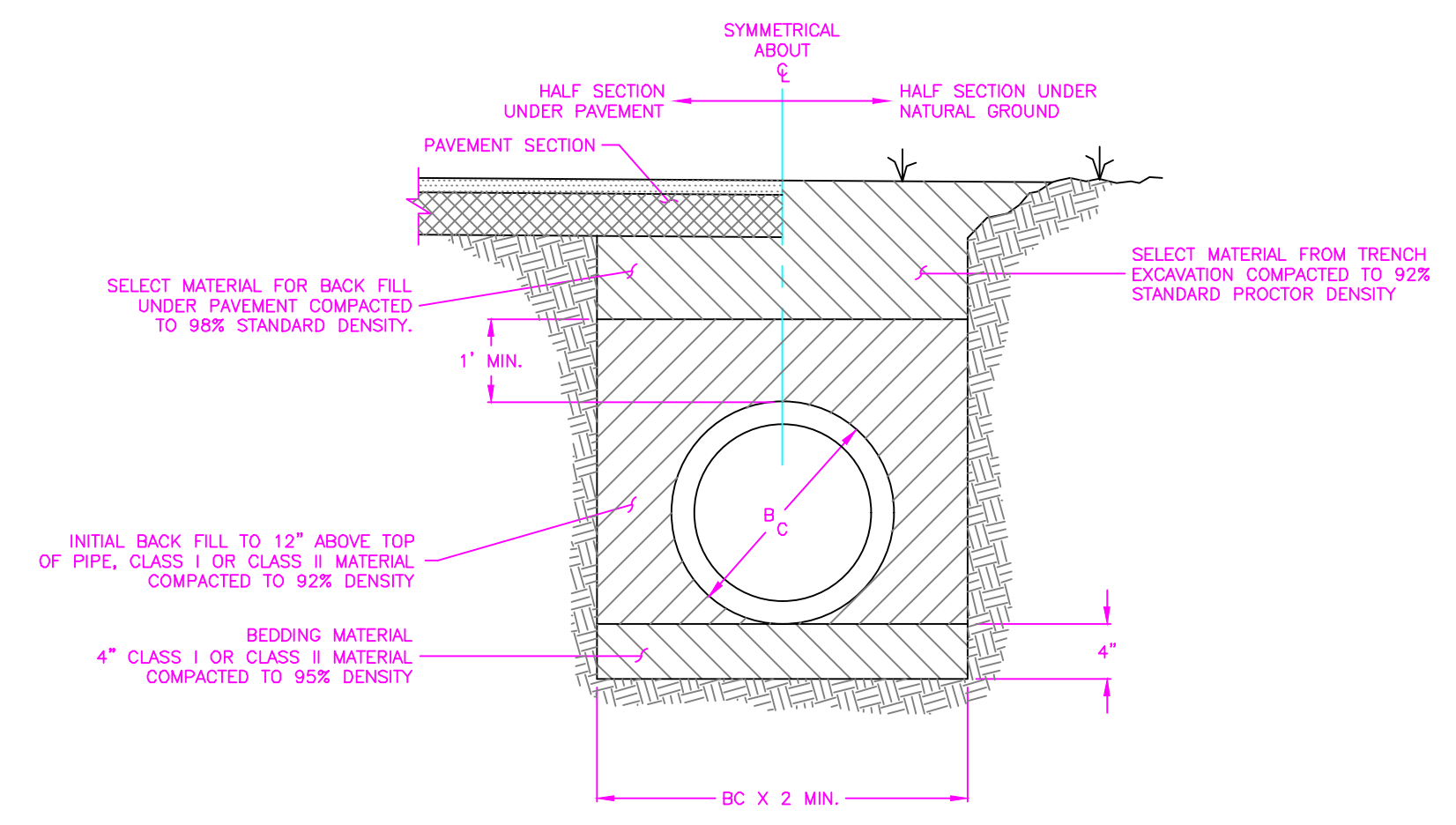

TYPICAL CMP STORM SEWER TRENCH DETAIL
NOT TO SCALE

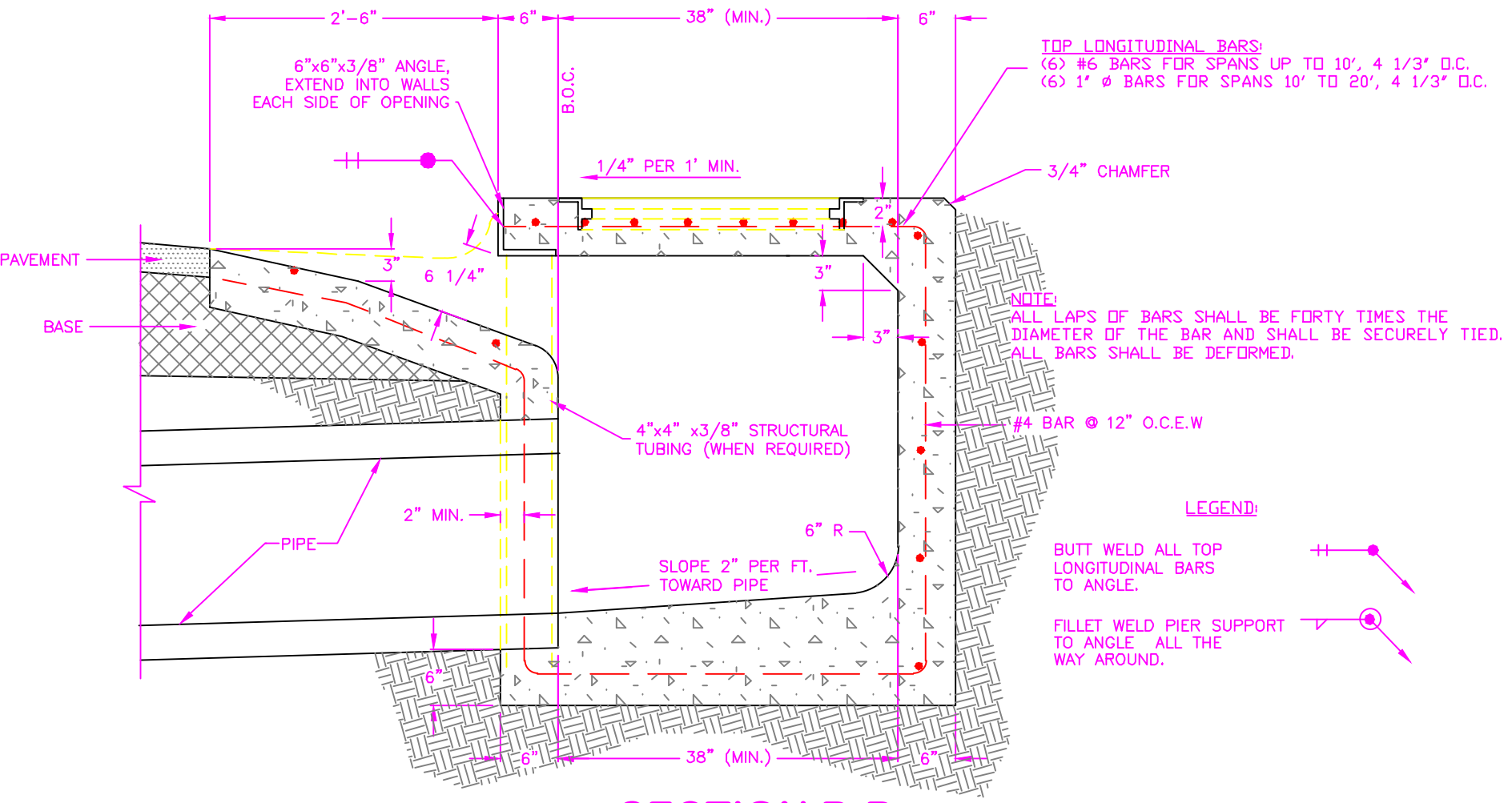

SECTION B-B
NOT TO SCALE

STORM SEWER NOTES:
 1. CURB & GUTTER AND INLET SHALL BE TIED TOGETHER WITH TWO #4 BARS TWO FEET (2') LONG. ONE BAR SHALL BE CENTERED IN THE TOP SIX INCHES (6") OF THE CURB & GUTTER AND THE OTHER SHALL BE CENTERED IN THE OUTER SIX INCHES (6") OF THE TOE.
 2. PRECAST INLETS ARE ACCEPTABLE SUBJECT TO CITY REVIEW AND APPROVAL. IF PRECAST INLETS ARE SUBMITTED THEY SHALL HAVE THE SAME THROAT DETAIL AS THAT SHOWN, BE DESIGNED FOR HS-20 WHEEL LOADING, AND HAVE A GALVANIZED STEEL ANGLE ON THE CURB FACE. SUBMITTALS SHALL BE DETAILED AND DOCUMENTED TO INDICATE COMPLIANCE WITH LOADINGS AND PHYSICAL PROPERTIES.
 3. MANHOLE FRAME AND COMPOSITE COVER SHALL BE EQUIPPED WITH A SECURABLE LID WITH A MINIMUM OF TWO (2) STAINLESS STEEL BOLTS COUNTERSUNK INTO LID AND THREADED INTO FRAME.
 4. AT CULVERT HEADWALL SAFETY END TREATMENTS, REFER TO CURRENT TxDOT REQUIREMENTS AND DETAILS.

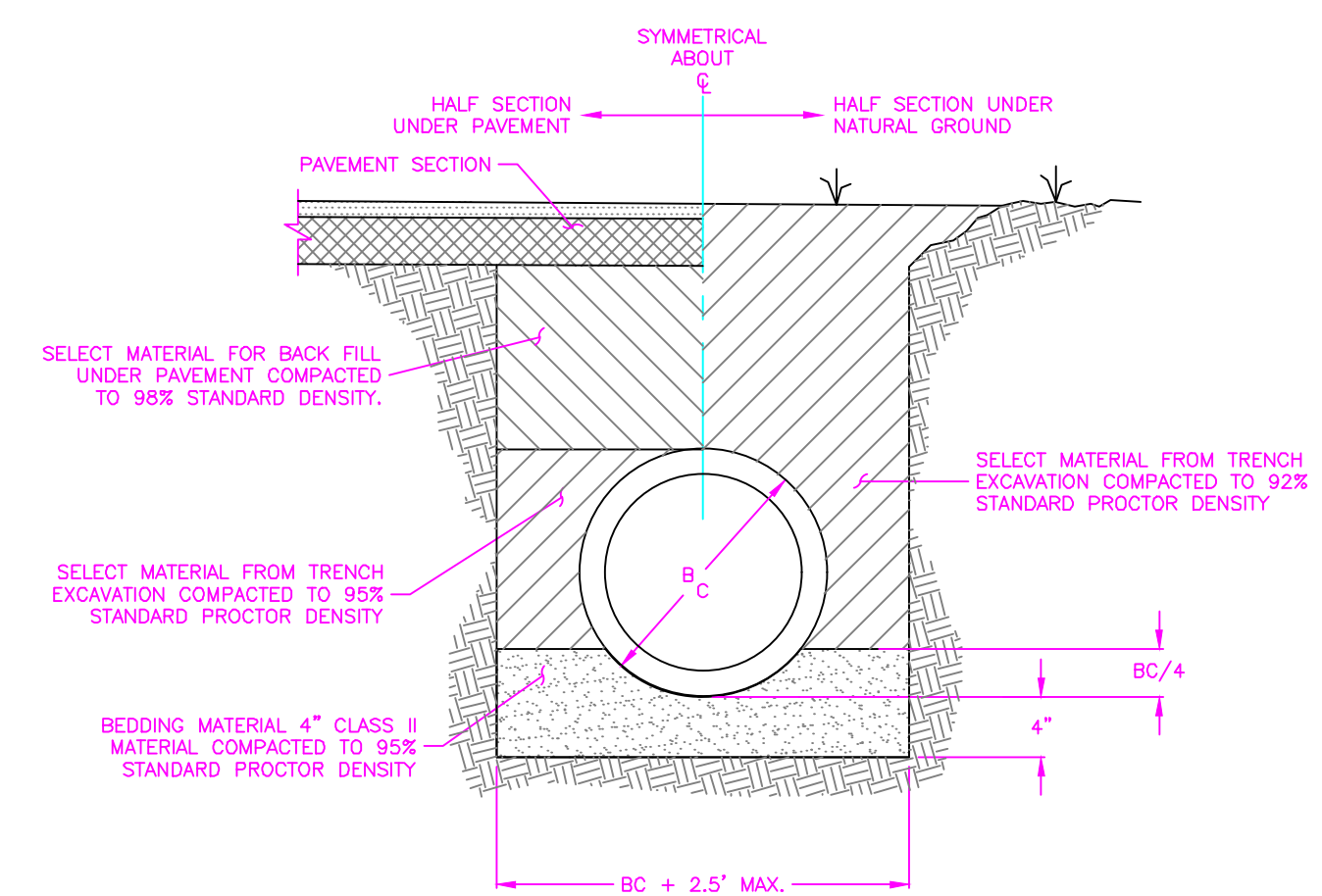

TYPICAL RCP STORM SEWER TRENCH DETAIL
NOT TO SCALE

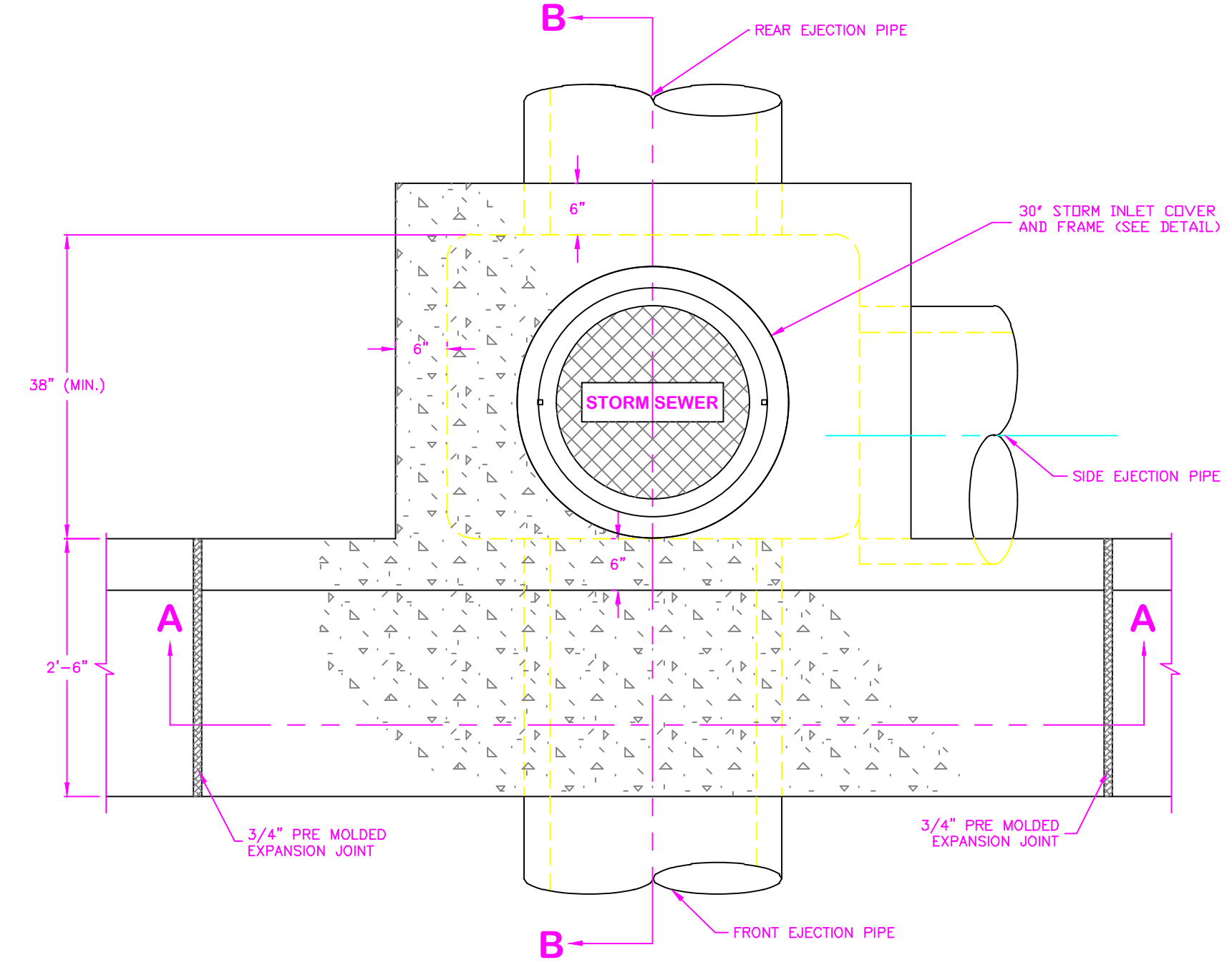

STANDARD BOX FOR STORM SEWER INLETS
NOT TO SCALE

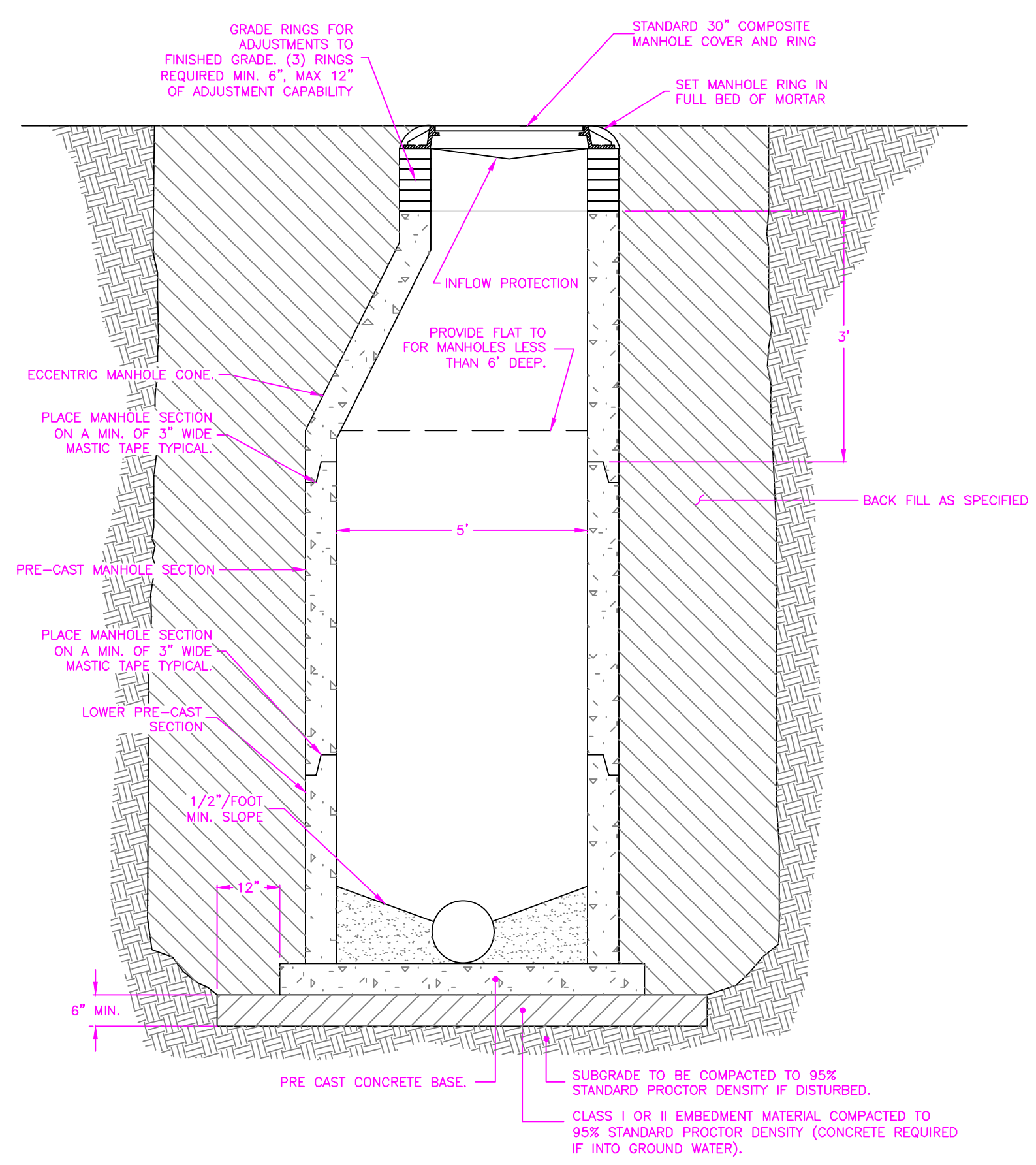

PRECAST STORM SEWER MANHOLE
NOT TO SCALE

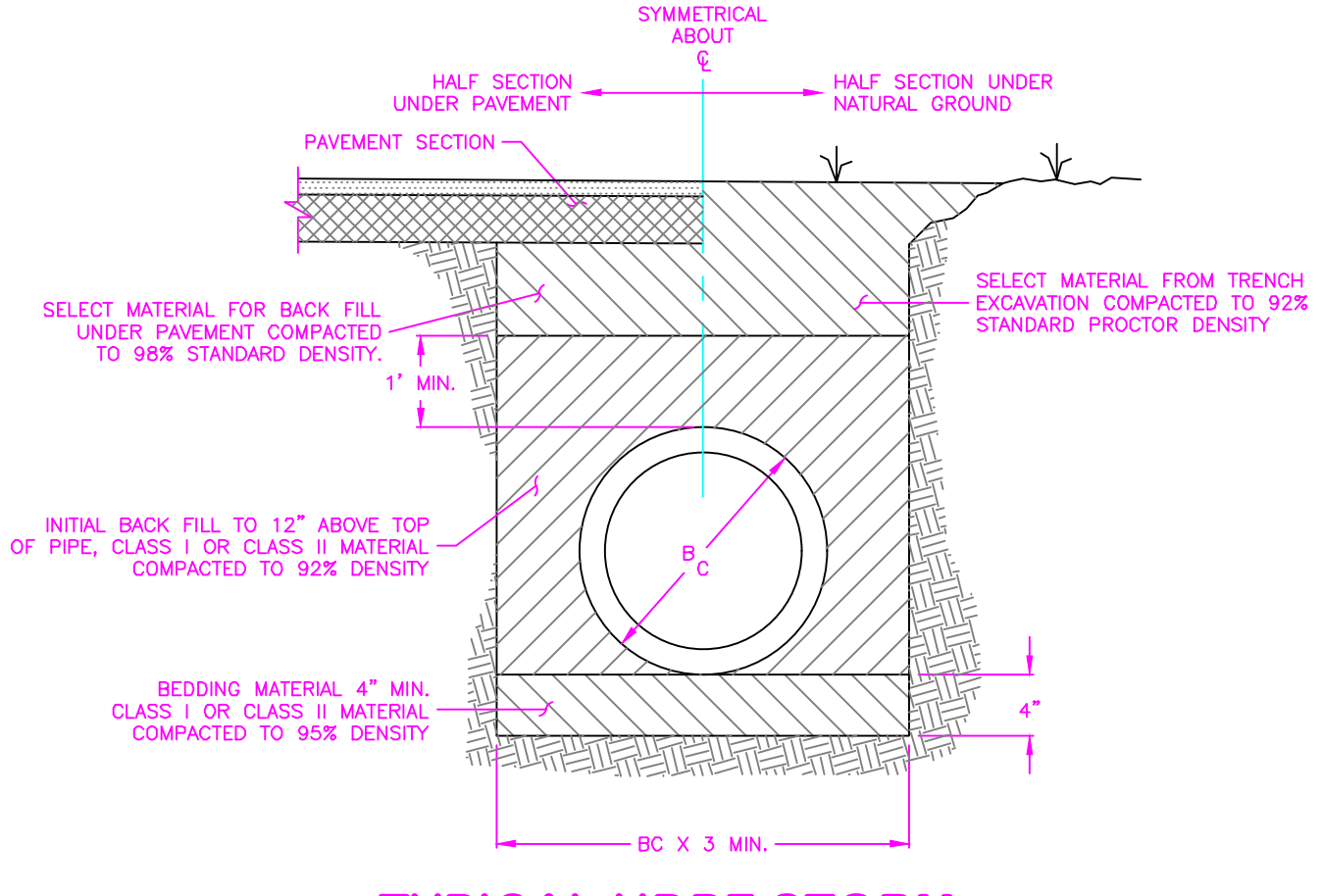

TYPICAL HDPE STORM SEWER TRENCH DETAIL
NOT TO SCALE